

### Digital Signage

### Bus Station

### Outdoor

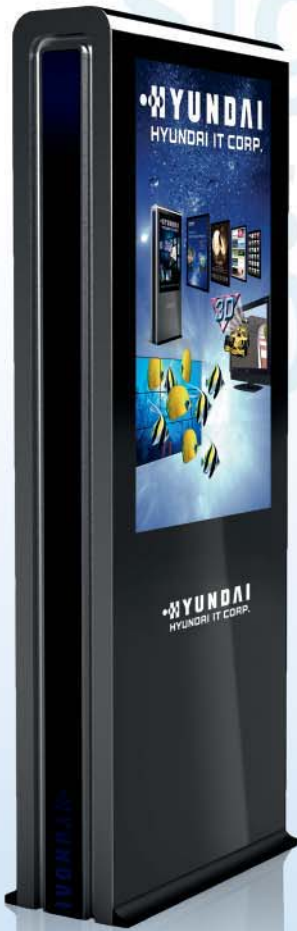

### Key Features

- 70" LCD TFT public display
- DOOH media panel
- LED Backlight
- 2000 cd/m<sup>2</sup> high brightness
- 1920 x 1080 resolution
- 2500:1 high contrast
- 178° (h/v) wide viewing angle
- anti-vandal bonding glass
- anti-refelction coating (option)
- anti-graffiti coating (option)
- all-weather proof (IP 66 certified)
- auto brightness control
- auto heating & cooling system
- remote control & maintenance

## H705AL – Outdoor Stand-Alone

Since the mid-90s, the name HYUNDAI has been synonymous with the design and production of state-of-the-art display technologies. Advanced devices offering sophisticated design and supreme image quality – with "built-in" future-proofing.

HYUNDAI IT's outdoor displays are representing state-of-the-art display equipment for any outdoor environment. Meeting high industrial standards they are providing a high degree of operational reliability and high quality image, which are important preconditions for attracting successfully the attention of the audience.



Pictures are similar to original product.

Display Panel	Screen Size	70"   177,8	
	Panel Type	S-PVA	
	Active Display Area (mm)	1549,44 (H) x 871,56 (V)	
	Number of Pixels	1920 x 1080 (WXGA)	
	Pixel Pitch	n/a	
	Aspect Ratio	16 : 9	
	Display Colors	16.7 M	
	Brightness (typ.) (cd/m <sup>2</sup> )	2000	
	Contrast Ratio	2500 : 1	
	Response Time (ms, GTG)	8	
	Viewing Angle (h/v)	178°/178°	
	Life Time (h)	30,000	
	Backlight type	LED	
Connectivity	Input	VGA (15pin D-Sub)	1
		HDMI	1
Power Requirement	Operating Voltage	100 – 240VAC	
	Consumption (typ.) (W)	tbd	
	Consumption Heater Block (typ.) (kW)	2.0 (peak: 4.0)	
	Consumption per nits (W)	tbd	
Features	Auto Cooling System	Yes	
	Auto Heating System	Yes	
	Anti-Vandal Glass	Yes (thickness: 11,5 mm)	
	Anti-Graffiti Surface	Option	
	Auto Brightness Sensor	Yes	
	Touch Screen	No (option: model H705ALI)	
Mechanical	Dimension (mm)	Set   Packed (W x H x L) (mm)	1270 x 2428 x 302.8 (Base: 320)   2750 x 1560 x 723
	Weight (kg)	Set   Packed (kg)	tbd
	Surface treatment	Surface treatment	Powder coated
	Accessories	Mounting (Bottom mounting)	M10 wedge anchor (4 pcs)
Environmental conditions	Temperature operational	max.   min. (°C)	50   -40
	Temperature storage	max.   min. (°C)	60   -40
	Humidity (non-condensing) (%)		20 – 80
Approvals	EMI/EMC	tbd	
	Safety	tbd	
	Ingress Protection	IP66	
EAN Code	n/a		

## Mechanical Drawing

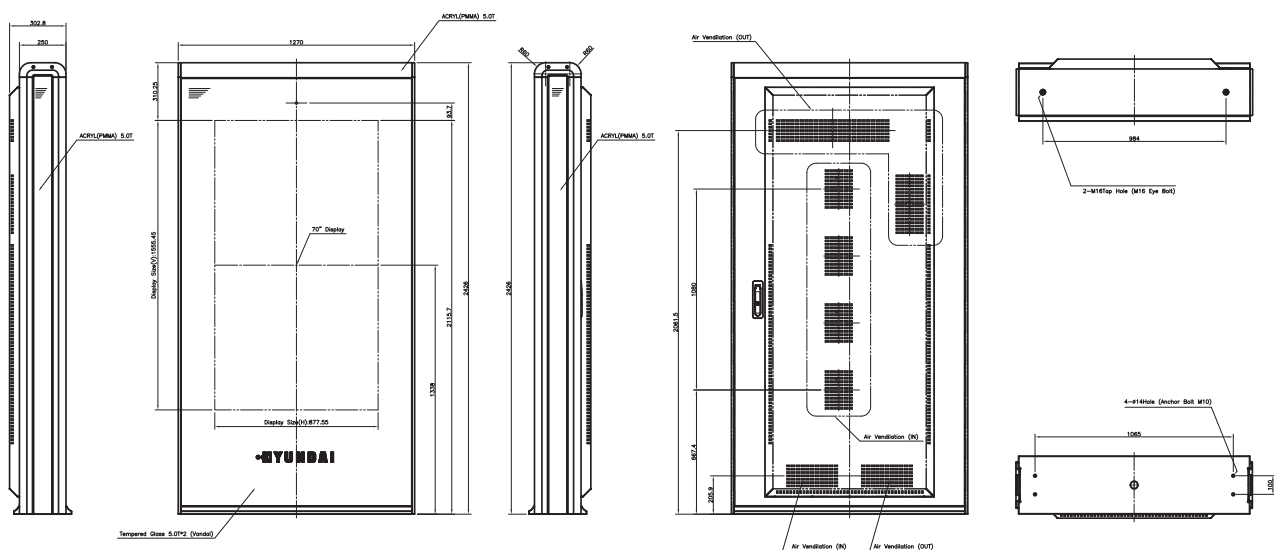

Technical details are subject to change without further notice. Errors excepted. Version: as of May 2011